



## ROMAN CITY OF COMPLUTUM

### The Monumental Group of Forum



RED DE PATRIMONIO HISTÓRICO DE ALCALÁ



ALCALÁ DE HENARES  
AYUNTAMIENTO



Complutum, one of the largest and most important towns in central Roman Hispania, was the name of present Alcalá de Henares. Although there was a pre-roman Complutum, the town's final location was decided on the Henares' fertile plain. We can distinguish two successive foundations: the first one around the beginning of Christian Era and the second one around 50-60 A.D.

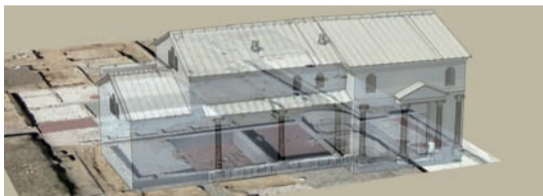

In the middle of this large 50 ha town there was the forum, the main square located on the crossroads of two of the main streets: Decumanus III and Kardus Maximus. There the inhabitants, called complutenses, built the town's main administrative, commercial, juridical and religious buildings. Those which can be visited nowadays are located to the South and West since eastern forum still remains under the modern town. Not all buildings date from the same period. Although the forum was built around 50-60 A.D. it underwent an important restoration at the end of IIIrd century A.D. Today we can visit the Monumental Façade, the Basilica, the Northern Baths, the Southern Portico, the Market, the Southern Baths, The Curia and the Cryptoporticus.



The Forum as it was 1700 years ago: top, Monumental Façade. Centre, Southern Baths. Bottom, Basilica.

#### 1. THE MONUMENTAL FAÇADE

Of breathtaking impact, the monumental façade served to embellish the forum as one approached it from the West. Built at the end of IIIrd century A.D., it was covered with marbles and decorated with sculptures and a commemorative poetic inscription (carmen epigraphicum).

#### 2. STREETS AND WATER SUPPLY

Several drains and water pipes have been found under decumanus III and IV.

#### 3. THE PAREDÓN DEL MILAGRO (MIRACLE'S WALL)

Of great historical importance for Alcalá, the Basilica's and Curia's Northern façades became worshipping places for christians for many centuries since tradition places here the martyrdom of Saints Justo and Pastor in 303 A.D.

#### 4. THE NORTHERN BATHS AND THE CURIA

Built by the Basilica between 50-60 A.D., they were the town first public baths (Northern Baths). However they lost their function at

the end of IIIrd century A.D when they became the curia, a space devoted to senate meetings and also the word defining the members of the senate themselves.



RED DE PATRIMONIO HISTÓRICO DE ALCALÁ

YACIMIENTOS VISITALES

EM  
La Suma de Todos  
Comunidad de Madrid  
www.madrid.org

ALCALÁ DE HENARES  
AYUNTAMIENTO

2016  
ALCALÁ  
Ciudad Europea de la Cultura

www.ayto-alcaladehenares.es



#### 5. THE BASILICA

This building hosted commercial agreements and was used as court of justice as well. Built between 50-60 A.D., it was deeply restored at the end of IIIrd century A.D.

#### 6. THE FORUM SQUARE

Most of monumental buildings were located around this open space.

#### 7. THE SOUTH PORTICO

Commercial portico with shops and workshops (among them a mosaicist and painter workshop).

#### 8. THE SOUTHERN BATHS

They were built at the end of IIIrd century A.D. to replace Northern Baths as they had already lost their hygienic use.

#### 9. THE MARKET

This is a basic products and meat market. In fact there are two different markets: the first, dating 50-60 A.D., is a close covered structure. The second, dating IIIrd century A.D., is an open square with removable wooden stalls.

#### 10. THE CASA DE LOS GRIFOS (GRIPHON'S HOUSE)

At present it is not part of the visit since works on a covering structure are going on to preserve its delicate remains. It is a private dwelling built between 50-60 A.D. whose main feature is the preservation of most of its wall paintings.

#### 11. THE CRYPTOPORTICUS

Cryptoporticus, very frequent in Roman architecture, are underground structures over which the Romans used to build one or two floor buildings.

#### 12. THE ROMAN BOTANICAL ROUTE

Around the site limits we can recognise and appreciate the most usual roman gardening species taking part of a modern garden.



The Monumental Group of Forum is part of the **Roman Town of Complutum Archaeological Route** within the Alcalá's Historical Heritage Framework and the CAM Open Sites Framework.



#### ADDRESS

Camino del Juncal, s/n (on Gonzalo Gil street junction). Alcalá de Henares.

Local buses: 1 and 6. ●

Coming from Madrid:

- Suburban Train: C2 and C7 lines, La Garena Station. ●

- Coach lines: 223 (Madrid, Avenida de América, Alcalá de Henares former National Road II - Liade). ●

#### FEE 1€.

Free entrance for all visitors under 10 and over 65.

Reduced fee of 2€ when visiting three sites: Casa de Hippolytus, the Forum monumental complex, Centro de Interpretación del Burgo de Santiuste and Santa María tower.

Specific contents for children.

#### ACCESSIBILITY

More information on [www.turismoalcala.com](http://www.turismoalcala.com) and [www.ayto-alcaladehenares.es](http://www.ayto-alcaladehenares.es).

#### TIMETABLE

Summer (May to September): from 10'00 a.m. to 14'00 p.m. and from 17'00 p.m. to 20'00 p.m.

Winter (October to April): from 10'00 a.m. to 14'00 p.m. and from 16'00 p.m. to 18'00 p.m. Closed on Mondays.

#### MORE ROMAN PLACES TO VISIT

Casa de Hippolytus. Roman City of Complutum.